

**INSTRUCTION MANUAL
AND
PARTS CATALOGUE
FOR**

**THE ALBUTT RANGE OF
YARDSCRAPERS**

**THIS MUST BE USED IN CONJUNCTION WITH ALBUTT'S
GENERAL OPERATOR'S MANUAL**

Model	Width	Blade Height	Depth	Weight
YS50GV	2.2m to 3.1m	530 mm	1130 mm	490 kgs
YS30GV	1.8m to 2.7m	530 mm	1130 mm	470 kgs

SCRAPE POSITION

With the blade on floor, the pivot pin should be positioned in the centre of the slot. The pivot pin will float up and down inside the slot to accommodate gradients and uneven surfaces. Excessive down pressure on the pivot pin should be avoided. The weight of the blade provides sufficient ground pressure.



LIFT POSITION

The blade can be lifted and kept in the horizontal plane. The hook at the base of the pivot arm should be hooked under the plate adjacent to the main pivot pin. This can be achieved by lowering the telehandler boom and crowding the top of the carriage back towards or away from the handler, depending on position of the scraper blade.



TO REVERSE BLADE

Lift the boom of the telehandler allowing the pivot pin to rest in the bottom of the floating slot. Lift the scraper blade clear of ground allowing it to swing. Lower the boom allowing the blade to rest on the floor on rocker plates. Carefully drive the machine forwards or backwards allowing the scraper blade to roll over. Position the main pivot pin in the middle of the float slot and continue to scrape.



YS50GV 2.2m to 3.1m YARD SCRAPER - SPARES

DO NOT SCALE - IF IN DOUBT ASK.

ITEM NO	PART NUMBER	ISS	DESCRIPTION	QTY
1	01-0628GV (Center) (4)		CENTER BLADE	1
2	01-0628GV-W	2	WING	2
3	01-30-21-SP	1	PIVOT PIN	2
4	01-40-1-40P	1	PIN	2
5	01-0628GV-BF	1	MAIN FRAME	1
6	01-0628-28	2	MAIN FRAME RUBBER	2
7	01-0628-29	2	WING RUBBER	4
8	PC80806	-	BOX SECTION CAP	4
9	01-0901-K	1	LOCKING PIN	2
10	01-0628-03L (2)	2	YS50 CENTRE RUBBER CLAMP PL	2
11	01-0628-04L (2)	2	YS30 / YS50 SIDE RUBBER CLAMP PL	4
12	FS11MMMLP	-	LYNCH PIN	2
13	FSM10608L	2	M10 Nylock Nut	4
14	FSM10LN			40
15	FSM12808L		M12 Nylock Nut	40
16	FSM12LN			2
17	FSM10708L		M10 Bolt x 70 Lg	2

THIRD ANGLE PROJECTION

A2

WELD SYMBOLS TO BS EN 22553
WELDS TO BE FREE
FROM DEFECTS.

THIS DRAWING IS THE PROPERTY
OF ALBERT LTD. AND MUST NOT
BE REPRODUCED OR
COPIED IN ANY MANNER
WITHOUT THE WRITTEN
CONSENT OF ALBERT LIMITED 2018

SHEET OF

D.M.G

DATE

6-3-18

MODIFICATION

NEW DRAWING

ISS

UNENLARGED DIMENSIONS

SIZE TOLERANCE

0 UP TO 500 ±1.1

501 UP TO 1000 ±1.2

1001 UP TO 2000 ±1.5

2001 AND ABOVE ±0.5

ANGLES ±0.5°

DRILLED HOLES ±0.2

ALL DIMENSIONS IN mm

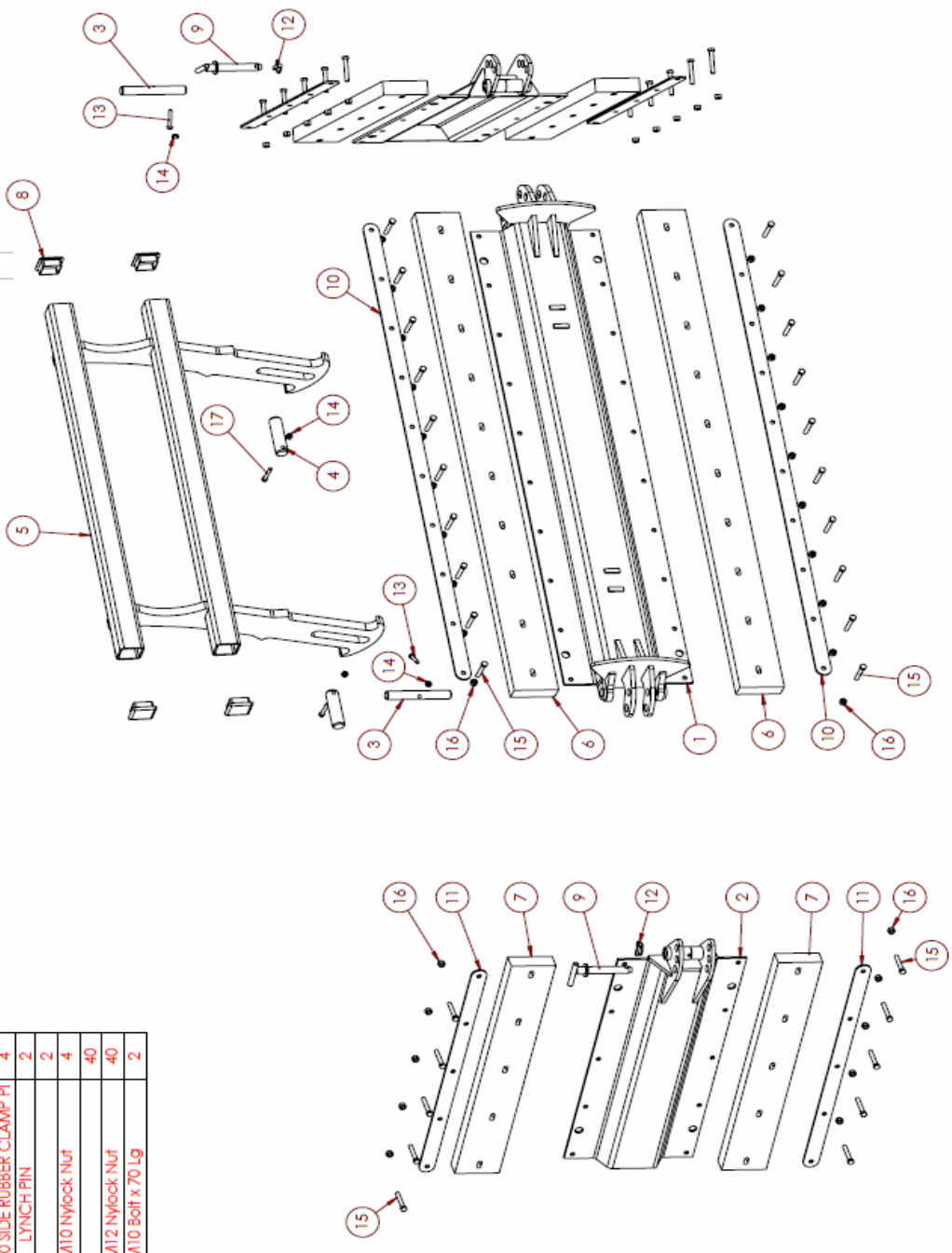

YS30GV 1.8m to 2.7m YARD SCRAPER - SPARES

SHEET OF D.M.G.

albutt
© Albutt Limited 2018

ISS MODIFICATION DATE
1 NEW DRAWING 6-3-18

WELD SYMBOLS TO BE IN 22553
THE DRAWING IS THE PROPERTY
OF ALBUTT LTD. AND MUST NOT
BE REPRODUCED OR COPIED
FROM OFFICE.

UNFINISHED DIMENSIONS
SIZE TOLERANCE
0 UP TO 500 ±1
501 TO 1000 ±1.5
1001 UP TO 2000 ±2
2001 AND ABOVE ±3
ANGLES ±0.5°
DRILLED HOLES ±0.2
ALL DIMENSIONS IN MM

A2 THIRD ANGLE PROJECTION

DO NOT SCALE - IF IN DOUBT ASK.

REVISED	PART NUMBER	ISS	DESCRIPTION	QTY
1	01-0630GV (Center) (4)			1
2	01-0628GV-W	2	WING	2
3	01-30-216P	1	PIVOT PIN	2
4	01-40-140P	1	PIN	2
5	01-0628GV-BF	1	MAIN FRAME	1
6	01-0630-28	2	MAIN FRAME RUBBER	2
7	01-0628-29	2	WING RUBBER	2
8	PC80806	-	BOX SECTION CAP	4
9	01-0901-K	1	LOCKING PIN	2
10	01-0630-03L (2)	2	YS30 CENTRE RUBBER CLAMP PI	2
11	01-0628-04L (2)	2	YS30 / YS50 SIDE RUBBER CLAMP PI	4
12	FS11MM/LP	-	LYNCH PIN	2
13	FSM10608L			2
14	FSM10LN		M10 Nylock Nut	4
15	FSM12808L			36
16	FSM12LN		M12 Nylock Nut	36
17	FSM10708L		M10 Bolt x 70 Lg	2

