

INSTRUCTION MANUAL AND PARTS CATALOGUE FOR

ALBUTT BALE HANDLERS (SQUEEZE VERSIONS)

**THIS MUST BE USED IN CONJUNCTION WITH THE
ALBUTT GENERAL OPERATOR'S MANUAL**

CONTENTS

Certificate.....	3
Safety Instructions.....	4-6
Capabilities.....	7
Operating Instructions.....	8-9
Hydraulic Safety.....	10
Parts Diagrams.....	11-14



EU CERTIFICATE OF CONFORMITY

CONFORMING TO EC Machinery Directive 2006/42 EC

We:

Albutt Limited
Great Washbourne
Tewkesbury
Glos. UK
GL20 7AR



declare in sole responsibility, that the product

Type: F301, F352, F410, F450

to which this certificate applies, conforms to the basic safety
and health requirements of the EC Machinery Directive 2006/42 EC,
and the Transposed Harmonised Standards:

BS EN 1553 (2000)

A handwritten signature in black ink, appearing to read "A. D. Albutt".

Alistair Albutt

Managing Director



SAFETY INSTRUCTIONS

IMPORTANT – READ BEFORE USE

This manual is provided to assist you in getting the best results from your machine and ensure that you do so safely. If you have any queries about the use of the machine contact your dealer before use. Please keep this manual for future reference.

INTENDED USE

The intended use of Albutt bale spikes and grabs (F range) is for the safe lifting of compacted bales of straw, hay, haylage and silage both wrapped or unwrapped using user preference to prevent damage to wrap. These products must only be used for this purpose and under no circumstances should be used as a lifting device or access platform.

1.1 FUNDAMENTAL PRECAUTIONS

On delivery, your dealer gave you an explanation of the operation and maintenance of this Albutt attachment. Please read and understand these operating instructions before operating the attachment for the first time. It is essential that you observe all safety instructions.

Incorrect use or mishandling of the machine can endanger:

Life and Limb of the operator, other persons or animals within the vicinity of the machine.

The machine and other material assets of the owner or third persons.

The performance of the machine.

Anyone who is involved in the commissioning, operation or maintenance of the bale grab must read and understand these instructions very carefully and observe them at all times.

NEVER DISTRACT ANYONE WHO IS USING A MACHINE.

1.2 AUTHORISED OPERATORS

Youths under the age of 16 must not operate this attachment. The owner of the bale handler must provide the operator with the operating instructions and make sure they have read and understood them. Only then may the bale handler be put into operation.

The owner must ensure that only authorised persons operate/work on this bale handler. The owner is responsible for keeping any third persons or animals out of the working area of the machine.

THE OPERATOR MUST BE FULLY TRAINED BEFORE USING THE IMPLEMENT ESPECIALLY WHEN MOUNTED ON A TRACTOR LOADER OR TELEHANDLER. A SAFE DISTANCE OF AT LEAST 10M MUST BE OBSERVED BY ANYONE WITHIN THE VICINITY OF THE BALE GRAB.

1.3 GENERAL SAFETY AND ACCIDENT PREVENTION REGULATIONS

Ensure the implement is correctly and securely attached to the operating vehicle using loader bracket mounting points. These do not come supplied with the attachment.

Always use the correct mounting bracket and ensure that it is fitted by a trained and competent operator who has been approved by your Albutt dealer. It is recommended to use a bolted connection to attach the mounting bracket.

NEVER attach to a tractor which would be rendered unstable when the implement is operated at its full capacity. Take note of the maximum load permissible on loader or linkage arms.

Take extra care when operating machinery on sloping ground. **NEVER** operate on ground where there is a risk of the tractor becoming unstable.

When the unit is stationary always ensure it is lowered to the ground.

When detaching the implement from the tractor always ensure that it is stable and safely positioned on a level surface.

The attaching and detaching of the implement must be carried out by only one operator. There should not be any other people in the vicinity of the implement or in the tractor.

Before operation make yourself familiar with all elements and controls of the machine as well as their functions.

Before operation inspect the area around you. Keep children away. All visitors and unauthorised persons should be kept well away from work area at all times.

Under NO circumstances should anyone, authorised or otherwise attempt to use the bale stacker as a means of personal transport. It is designed as a specialist purpose farm implement and is unsuitable for the safe transportation of passengers. **NEVER** allow anyone especially children to travel anywhere between the tractor and an implement.

NEVER use this implement to lift items other than bales of straw, hay or silage. Any attempt to overload the machine will risk life and limb of the operator and immediately invalidate warranty.

To avoid personal injury keep hands and limbs well away from the moving parts.

ENSURE the implement and bales, do not restrict the forward vision or important sightlines of the operator when mounted on the front of the tractor.

ENSURE that the operator is aware of the large overhang when the implement is mounted on the front of the tractor. **EXTREME CAUTION** must be taken when emerging onto the public roads. We recommend that the attachment is placed on a trailer when travelling on the public highway.

Never unload bales on sloping ground or anywhere where the bales could be unstable. If stacking bales always ensure that the ground is level and stable and the stack is secure and adequately supported.

NEVER attempt to move the implement manually.

We recommend that genuine Albutt bolt on brackets are used on these attachments.

Any weld on brackets which adversely affect the structure of the product and may invalidate warranty.



1.4 MACHINE CAPABILITIES

The Albutt bale handlers are capable of handling (bale sizes in cm - widthxheight):

HANDLER	QTY ROUND	QTY 80x90	QTY 120x90	QTY 120x70	QTY 80x70	QTY 80x50	QTY 120x120
F301	1	N/A	N/A	N/A	N/A	N/A	N/A
F352	1	1	1	1	1	1	1
F410	1	N/A	N/A	N/A	N/A	N/A	N/A
F450	1	2	2	2	2	2	1



1.4 GENERAL OPERATING INSTRUCTIONS

F301

- 1) Drive up to the bale and fully open the arms.
- 2) Drive in until the bale is up against the frame with the arms in the position shown below.
- 3) Operate the hydraulics to gently squeeze the bale.
- 4) Lift the bale and crowd so the bale is supported by the back frame. **DO NOT LIFT ANY BALES WHICH ARE UNSUPPORTED THE SUPPORTING BACK FRAME.**
- 5) **Before moving ensure the desired path is clear. Only ever travel in a path which is known to be clear and never allow the bales and handler to come within 10m of a bystander.**
- 6) To place the load position the bales very close to the destination before returning the bales to horizontal to prevent bales tipping off prematurely. Gently place down the bales and when the load is taken by the floor/trailer/other bales, release the hydraulics, lower the attachment and reverse out gently. If the bales begin to move adjust attachment position as necessary to prevent dragging. Do not drop the bale from any height, this may result in personal injury or damage to the bale.



1.4 GENERAL OPERATING INSTRUCTIONS

F410 & F450

- 1) Drive up to the bale and fully open the arms.
- 2) Drive in until the bale is up against the back frame.
- 3) Operate the hydraulics to gently squeeze the bale.
- 4) Lift the bale and crowd so the bale is supported by the back frame. **DO NOT LIFT ANY BALES WHICH ARE UNSUPPORTED BY THE BACK FRAME.**
- 5) **Before moving ensure the desired path is clear. Only ever travel in a path which is known to be clear and never allow the bales and handler to come within 10m of a bystander.**
- 6) To place the load, position the bale very close to the destination before returning the bale to horizontal to prevent bale tipping off prematurely. Gently place down the bale and when the load is taken by the floor/trailer/other bales, release the hydraulics and reverse out gently. If the bale begins to move adjust attachment position as necessary to prevent dragging. Do not drop the bale from any height, this may result in personal injury or damage to the bale.
- 7) When not carrying a bale, the F410 must be fully closed during travelling. When travelling on the road, transport the F410 on a trailer. If this is not possible, ensure it is carrier in the lowest possible position with the arms fully closed.



1.4 GENERAL OPERATING INSTRUCTIONS

F352

- 1) Drive up to the bale and fully open the arm.
- 2) Drive in until the back of the bale is against the bottom tube of the handler and lower until the top tube is resting on the top of the bale.
- 3) Operate the hydraulics to clamp the bale. Lift the bale and crowd so the bale is supported by the back frame. **DO NOT LIFT ANY BALES WHICH ARE UNSUPPORTED BY THE BACK FRAME.**
- 4) **Before moving ensure the desired path is clear. Only ever travel in a path which is known to be clear and never allow the bales and handler to come within 10m of a bystander.**
- 5) To place the load, position the bale very close to the destination before returning the bale to horizontal to prevent bale tipping off prematurely. Gently place down the bale and when the load is taken by the floor/trailer/other bales, release the hydraulics and reverse out gently. If the bale begins to move adjust attachment position as necessary to prevent dragging. Do not drop the bale from any height, this may result in personal injury or damage to the bale.



1.5 HYDRAULIC SAFETY

CAUTION The hydraulic system is under high pressure.

Ensure that only high-pressure hoses are used to connect supply to the attachments hydraulic cylinder. Check hoses regularly and renew any that are damaged or worn. **Hydraulic** supply must not exceed 207 bar & 80 L/min

Before working on the hydraulics lower the bale handler, release the pressure from the system and stop the tractor engine.

When connecting hydraulic rams make sure that the hydraulic hoses are coupled correctly. Pressure should be released from the system both on the tractor and on the implement side prior to coupling the hoses to the tractor hydraulics.

CAUTION Hydraulic oil forced out under pressure can break the skin and cause severe injury. In the event of a hydraulic oil leak stop the tractor flow immediately. **DO NOT PUT HANDS NEAR A LEAKING PIPE.**

1.6 MAINTENANCE

As a rule, disengage the driving system and stop the engine prior to carrying out maintenance, servicing, cleaning or repair work. **ALWAYS** remove the ignition key.

Prop the machine with appropriate supports before carrying out any maintenance work. The manufacturer will not be responsible for any damages or injuries caused by unauthorised repair, alterations or mishandling of the product.

Maintain product with care. Check periodically for damage that would affect the safe operation of the implement.

ALWAYS ensure all warning stickers are kept clean and in good condition.

Regularly check the bolts at the hinge points and tighten if necessary.

Regularly lubricate the hydraulic cylinder and hinges using clean grease.

Cover the chromed area of the hydraulic cylinder with a layer of grease during prolonged periods of inactivity.

2.1 F352 PARTS DRAWING (2018)

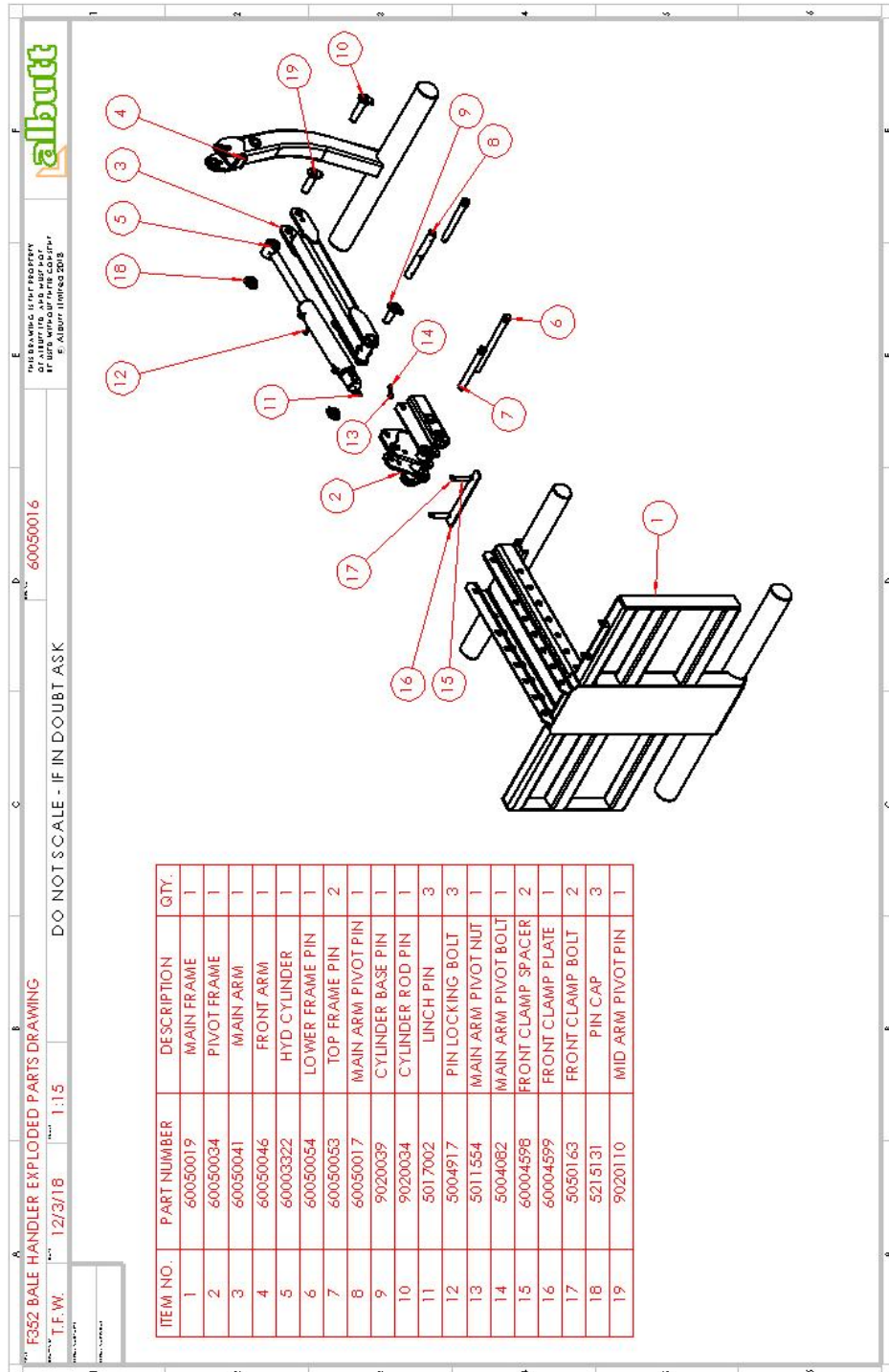

2.2 F450 PARTS DRAWING (2014)

